

# RULES FOR LIFTING , LOADING AND TRANSPORT

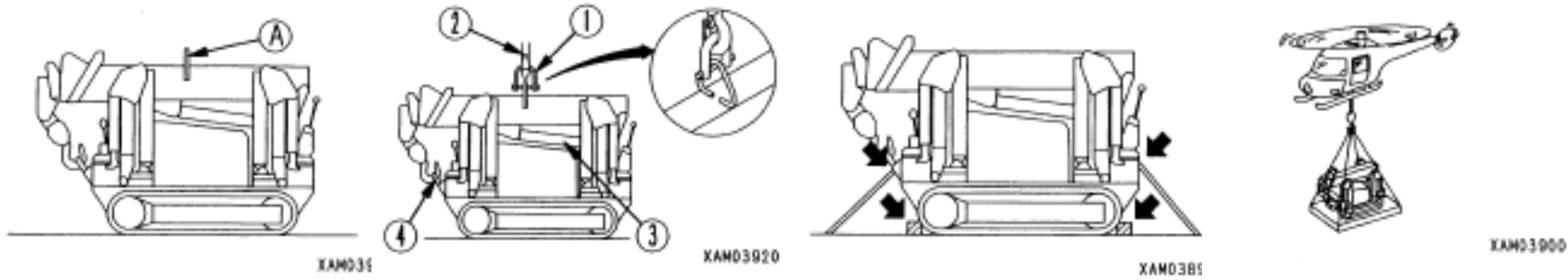

## MC104CR



**MC-104C** Total weight  
**1050kg**  
350-4431100

## MC174CR

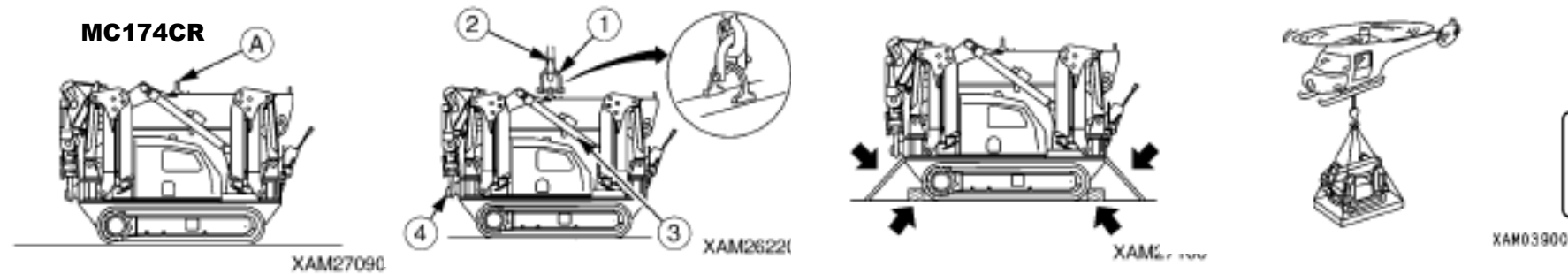

**MC174C** Total weight  
**1290kg**  
101-4080900

## MC285C-3

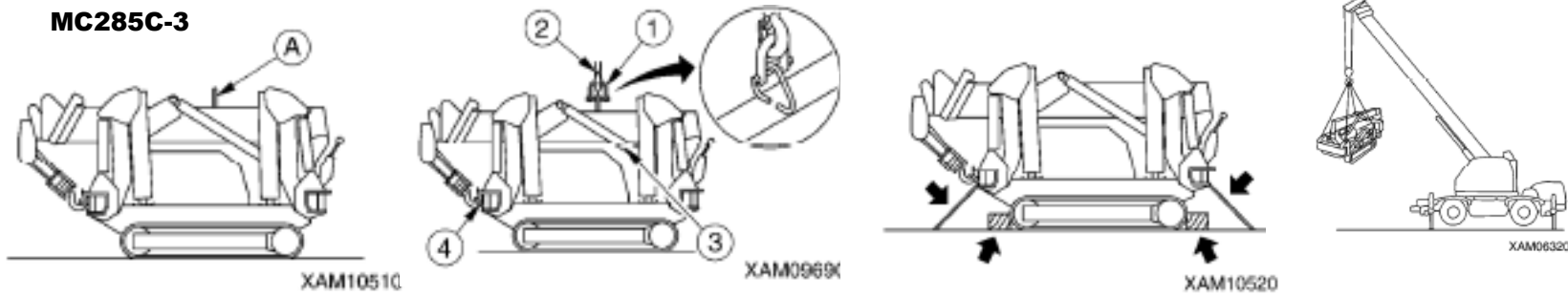

MC285C-3 MACHINE WEIGHT	
Component	Weight
Main Unit	1990 kg
Electric Unit	170 kg
Searcher Hook	22 kg
Auxiliary Winch	170 kg



### MK1033

More than 1.5m

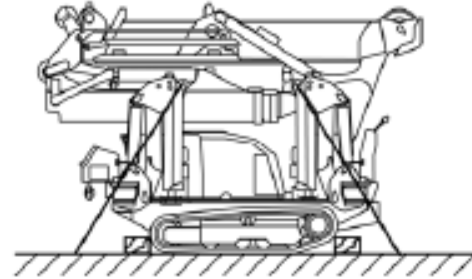
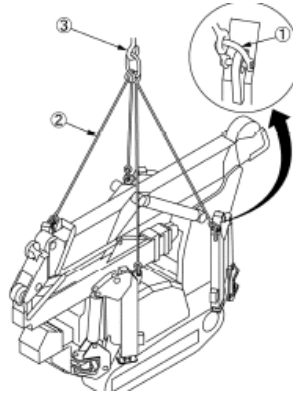
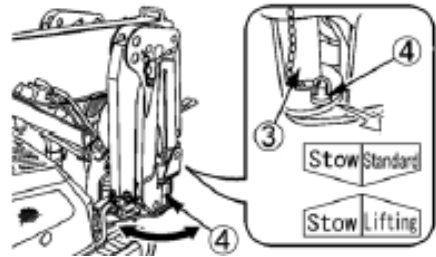
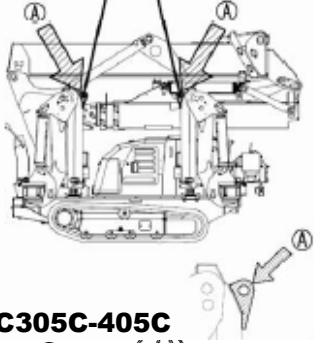

MK1033CW-1 MACHINE WEIGHT	
Model	Weight
MK1033CW-1	2090 kg
MK1033CW-1 with winch	2190 kg
MK1033CWE-1	2270 kg
MK1033CWE-1 with winch	2370 kg

103-4610360

### MC305C-405C

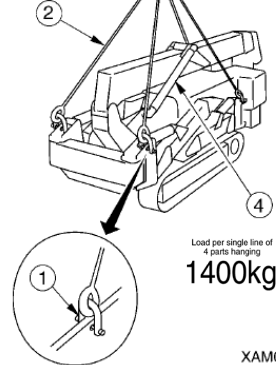

Load per single line of 4 parts hanging  
1400kg

Load per single line of 4 parts hanging  
975kg

XAM0633C

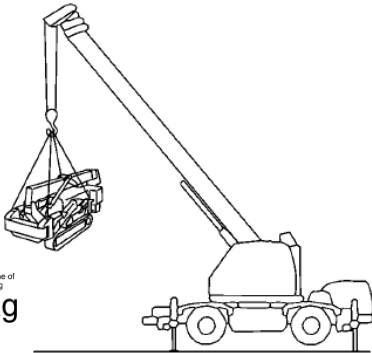

XAM06320

Fixing position during transportation

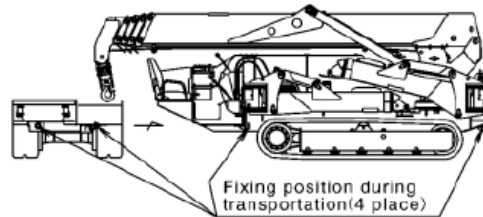

104-4548800

### MC405C-3 MACHINE WEIGHT

Component	Weight
Main Unit	5600 kg
Electric Unit	+150 kg
850kg Searcher Hook	+30 kg
Fly-Jib	+150 kg

MC-305C-2 Total weight  
**3900kg**

103-4610360

### MC815CWM

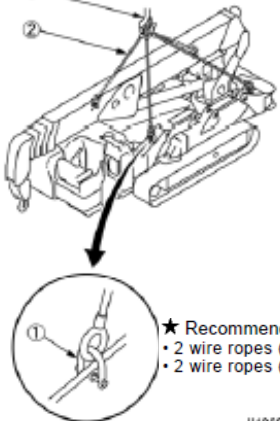

- ★ Recommended sling
- 2 wire ropes (front): Breaking load of 14.6 tons or more
- 2 wire ropes (rear): Breaking load of 14.6 tons or more

H10631 52

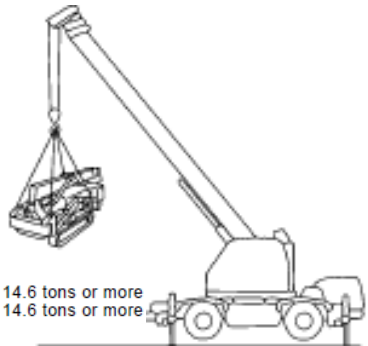

XAM06320

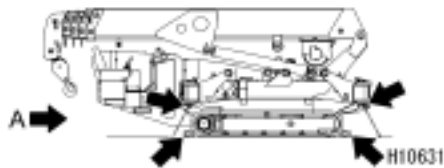
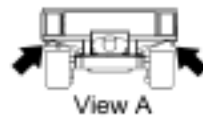

SAM1 9230

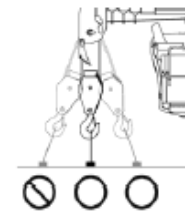

### MC815CWM MACHINE WEIGHT

Component	Weight
Main Unit	9460kg
Electric Unit	+240kg
Fly jib	+490kg
Searcher Hook	+60kg
Rubber Pads	+220kg



### CC423S-1

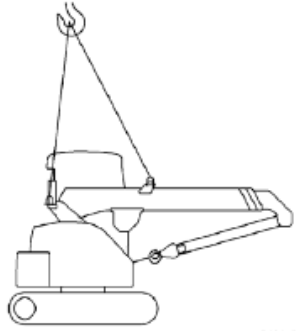

Wire rope: breaking load 96.7 kN or more (6 × 37 – φ14 × 2.5 m)  
 Shackle: working load 2.0 t or more Nominal 18 (except format SD)

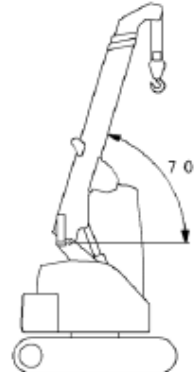
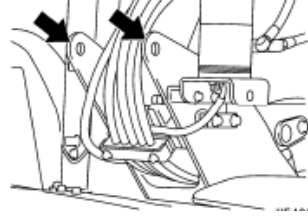
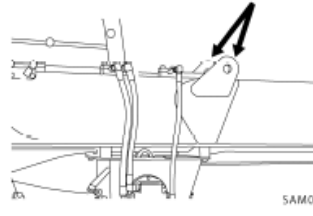

Wire rope: breaking load 160 kN or more (6 × 37 – φ18 × 2.5 m)  
 Shackle: working load 2.5 t or more Nominal 20 (except format SD)

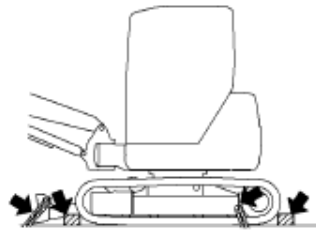
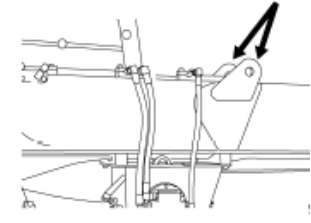
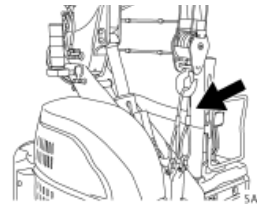

CC423S-1 MACHINE WEIGHT	
Model	Weight
CC423S-1	4400kg

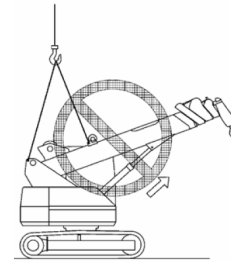

### CC985S-1

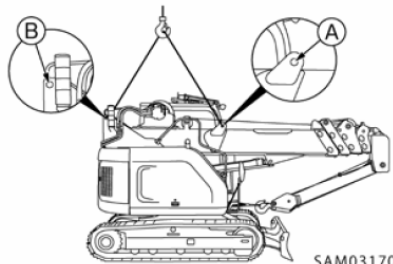

Wire cable: Breaking load: 18.7 t or more (6 × 37 - dia. 18 × 2.0 m or more)  
 Shackle: Using load: 7.0 t or more, Nominal size 34 SC type

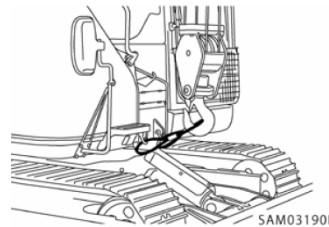
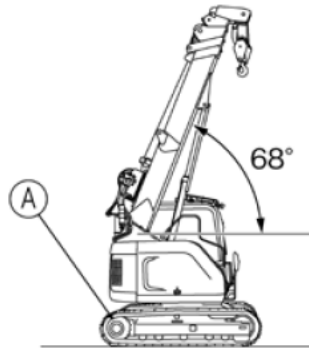

Wire cable: Breaking load: 36 t or more (6 × 37 - dia. 25 × 5.0 m)  
 Shackle: Using load: 7.0 t or more, Nominal size 34

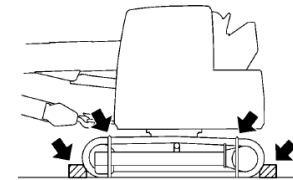
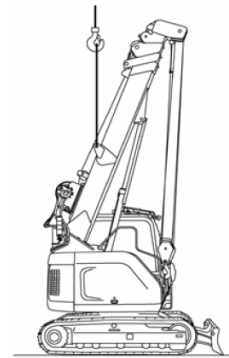

CC985S-1 MACHINE WEIGHT	
Spec	Weight
Main Unit	9450kg
Fly Jib	+180kg
Rubber Pads	+275kg



## CC1485S-1

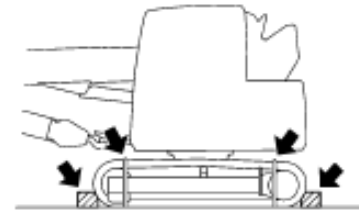
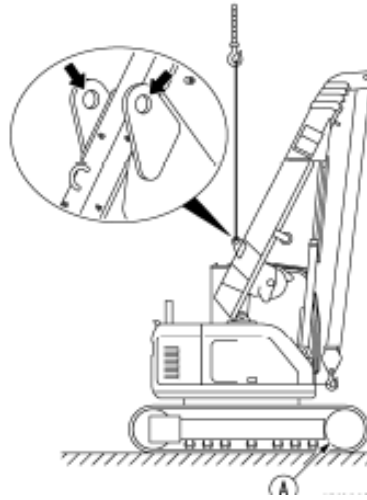
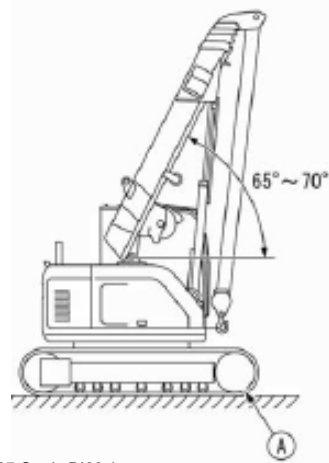
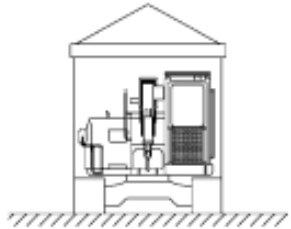
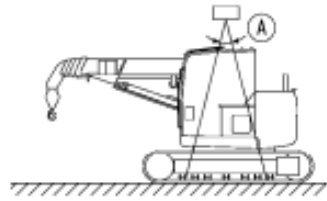

CC1485S-1 MACHINE WEIGHT	
Model	Weight
CC1485S-1	14400 kg
CC1485S-1F	kg

Wire rope: Breaking load 24,5 t or more JIS STD 6X37 Grade B\*22,4 x 8m or more. Shackle: working load 14t or more. JIS std Nom. Size 48

Wire rope: Breaking load 78,9t or more JIS std. 6 x 37 Grade\*37,5 x 6,9m Shackle working load 14t or more JIS std SB Nom.size 48

## CC1908S-1

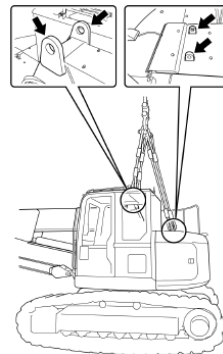
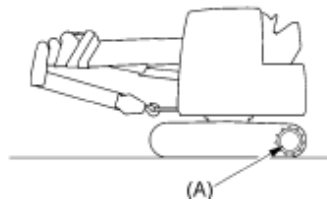

- Wire rope (Boom side):  
Breaking load not less than 60 tonnes  
• 1.0 m × 2 pieces
- Wire rope (Counter weight side):  
Breaking load not less than 15 tonnes  
• 1.8 m × 2 pieces
- Shackle (Boom side):  
Working load not less than 10.0 tonnes  
• 2 pieces (hole diameter 55 mm)
- Shackle (Counter weight side):  
Working load not less than 2.5 tonnes  
• 2 pieces (hole diameter 28 mm)

When lifting the machine, be sure to attach the hook block to the stowage rope. Take care not to over-tension the rope here.

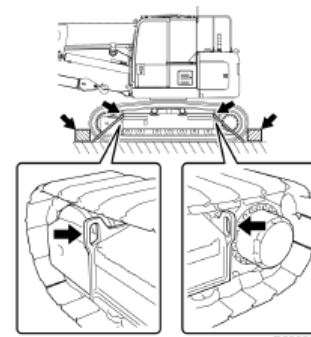

D5205036

CC1908S-1 MACHINE WEIGHT	
Spec	Weight
Main Unit	19400 kg
Fly Jib	+500 kg
Searcher Hook	+80 kg
Blade	+950 kg